

DUST CAP MARK

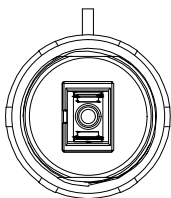

SUPERTAP/SCX ADAPTER

DUST CAP MARK

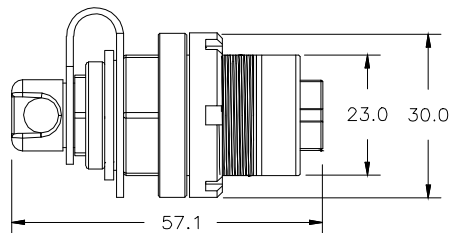
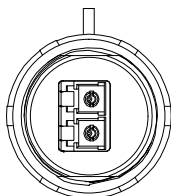
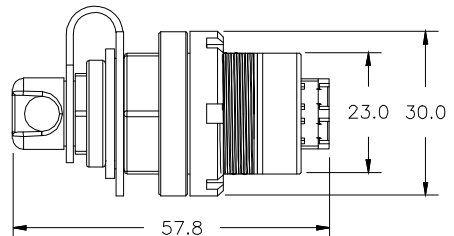

SUPERTAP/LCX ADAPTER

DUST CAP MARK

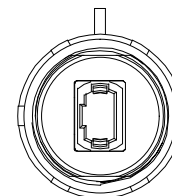
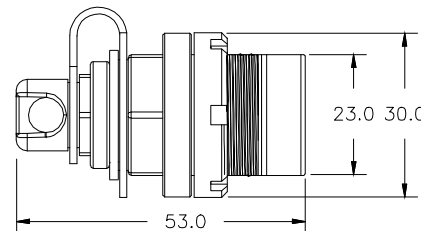
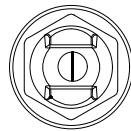

SUPERTAP/MPOX ADAPTER

NOTES:

1. COMPONENTS SHALL BE RoHS COMPLIANT
2. $IL \leq 0.3dB$ (SC&LC), $IL \leq 0.5dB$ (MPO)
3. IP67 PROTECTION
4. -40 to +85°C OPERATING TEMPERATURE
5. SC, LC, MPO DUST CAP NOT SHOW IN THIS DRAWING

PART NUMBER	DISCRIPTION
TAP-SCX-ADP	SUPERTAP/SC ADAPTER
TAP-LCX-ADP	SUPERTAP/LC ADAPTER
TAP-MPOX-ADP0	SUPERTAP/MPO ADAPTER(UP/DOWN)
TAP-MPOX-ADP1	SUPERTAP/MPO ADAPTER(UP/UP)

UNLESS OTHERWISE SPECIFIED TOLERANCE TO BE		NOTICE - These drawings are remain the property of HHT Communications		A	FIRST ISSUE	Lily	18-09-04	ALSN
LINEAR	ANGULAR	MATL: PER BOM	DRN:Alice Zhang	REV.	DESCRIPTION	APVD	DATE	ECO No
X.X ± .5	X' ± 1'	FINISH: ---	CKD:Perry Tse	TITLE: SUPERTAP ADAPTER		HHT COMMUNICATIONS		
X.XX ± 0.10	X'X' ± 30'	DO NOT SCALE	APVD: Jason Wong	DATE:18-09-04		Room 1103, Hony Seng Manlyok Building, 677 Nathan Road, Mong Kok, Kowloon, Hongkong		
X.XXX ± 0.050	X'X'X' ± 15'	DIMENSIONS IN CENTIMETERS		SCALE: N.T.S.	PART No: SEE PART NUMBER TABLE	SIZE: SEE PART NUMBER TABLE	DRAWING NO: SEE PART NUMBER TABLE	
		THIRD ANGLE PROJECTION						SHEET 1 OF 1